

Spencer Grove, Darlington, DL1 4HL  
Offers in excess of £169,995

**estates<sup>4</sup>**  
'The Art of Property'



# Spencer Grove, Darlington, DL1 4HL

## Offers in excess of £169,995

### Council Tax Band: A

Nestled at the head of this peaceful cul de sac in the popular Eastbourne area of Darlington, this charming semi-detached property offers a delightful blend of modern living and ample outdoor space. With three well-proportioned bedrooms, a nicely appointed ground floor bathroom, and a spacious reception room, this property is perfect for families or those seeking a comfortable home.

The heart of the home is the beautifully refurbished dining kitchen, featuring a newly fitted kitchen that is both stylish and functional. Extensive redecoration throughout the property, along with new carpets, creates a fresh and inviting atmosphere. The modern UPVC double glazing along with gas central heating with a newly fitted ( February 2026 ) Vokera combi boiler ensure a warm environment, making this home a practical choice.

One of the standout features of this property is the extremely large rear garden, which presents excellent potential for various uses. Whether you envision a vibrant garden space for family gatherings or require additional parking for a motorhome or caravan, this garden is sure to impress. Furthermore, there is a useful outside WC accessible from the side, and convenient parking for two vehicles at the front of the home.

Positioned within easy reach of Darlington's town centre, train station, and excellent links to the A1(M) & A66 this home offers both peace and accessibility. With no onward chain, this property is ready for you to move in and make it your own. Don't miss the opportunity to view this excellent opportunity that combines comfort with fantastic outdoor space.

Please note:

Council tax Band - A

Tenure - Freehold

Total sq ft and room dimensions to be considered a guide only.

Estates 'The Art of Property'

Professional Estate Agents, selling homes across Darlington, Newton Aycliffe, Teesside & North Yorkshire with creative & inviting marketing strategies! Property appraisals available 7 days a week!

Disclaimer:

These particulars have been prepared in good faith by the selling agent in conjunction with the vendor(s) with the intention of providing a fair and accurate guide to the property. They do not constitute or form part of an offer or contract nor may they be regarded as representations, all interested parties must themselves verify their accuracy. **No tests** or checks have been carried out in respect of heating, plumbing, electric installations, or any type of appliances which may be included. All photos, videos, and marketing material created by Estates 'The Art of Property', are the property of our agency and are protected by copyright law. Our marketing material must not be copied, reproduced, shared, or used in any way without our prior written permission.



# Spencer Grove, Darlington, DL1 4HL

Approximate Gross Internal Area: (893 sq ft - 83 sq m.)

**estates**<sup>4</sup>  
 'The Art of Property'

Business Central 2 Union Square  
 Central Park  
 Darlington  
 County Durham  
 DL1 1GL  
 01325 804850  
 sales@estatesgroup.co.uk  
<https://estates-theartofproperty.co.uk/>

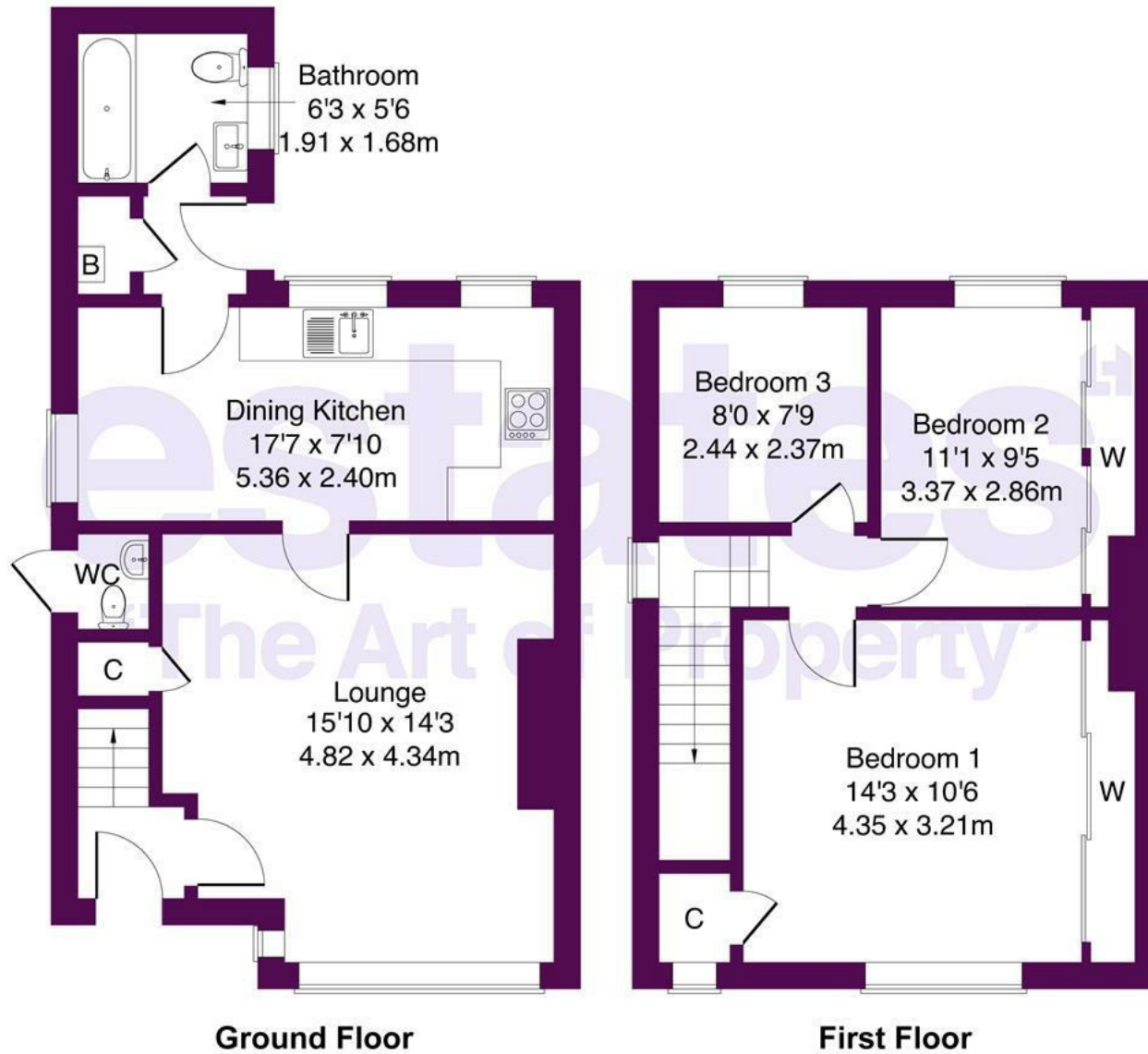

Not to Scale. Produced by The Plan Portal 2025  
 For Illustrative Purposes Only.

| Energy Efficiency Rating                    |  | Current                 | Potential |
|---|--|-------------------------|-----------|
| Very energy efficient - lower running costs |  |                         |           |
| (92 plus) <b>A</b>                          |  |                         |           |
| (81-91) <b>B</b>                            |  |                         |           |
| (69-80) <b>C</b>                            |  |                         | 78        |
| (55-68) <b>D</b>                            |  | 61                      |           |
| (39-54) <b>E</b>                            |  |                         |           |
| (21-38) <b>F</b>                            |  |                         |           |
| (1-20) <b>G</b>                             |  |                         |           |
| Not energy efficient - higher running costs |  |                         |           |
| <b>England &amp; Wales</b>                  |  | EU Directive 2002/91/EC |           |